



396-3824Y1

QuickStart for Marksman Installation

Step 1

- Connect 3/4" inlet hose to supply tank (2" female cam lever coupling) and to the Marksman 3/4" inlet Camlock.
P/N: 546-05-100100

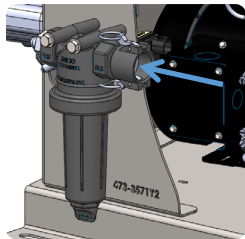

Step 2

- Connect 1/2" outlet hose to Marksman quick connect fitting and route to the injection point. *Note: Hose barbs and reducer bushings are included if the point of injection connection is not 3/8" QC.*

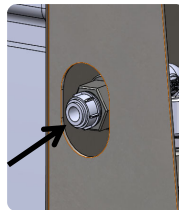

P/N: 546-05-100100

Step 3

- Plug Marksman Aux cable into auxiliary plug on main Marksman harness.
P/N: 208-08-3548Y1



Step 4

- Install pressure transducer (P/N: 521-05-050400) into irrigation pipe using the provided reducer bushings as needed.

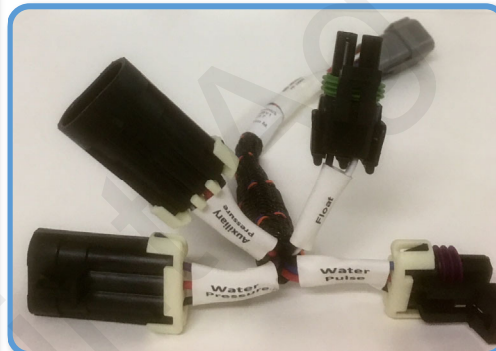
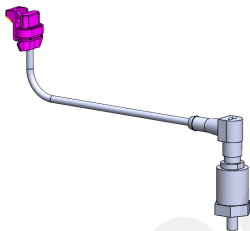

Marksman Auxilliary Harness
P/N: 208-08-3548Y1

Step 5

- Plug pressure transducer into Marksman Aux Harness connector labeled Water Pressure.
- 3-pin extension may be required.
P/N: 206-03-13207

Step 6

- Connect cellular and GPS antennas to Marksman Controller.

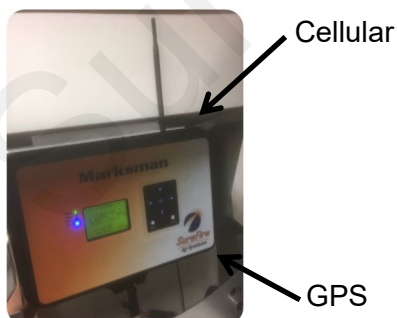

Step 7

- Connect water flow meter cable to Marksman Aux Harness connector labeled Water Pulse.
- 3-Pin Shroud and pins included for flowmeter wiring.
P/N: 379-02-030-12
- 3-Pin extension may also be required (P/N: 206-03-13207)

